

SCREWS FOR DRYWALLS

Name: Drywall screws

Codes: PL, PLRA, PLTR, PLCA

Reference: FT PLA-es

Date: 23/11/17

Revision: 6

Page: 1 de 6

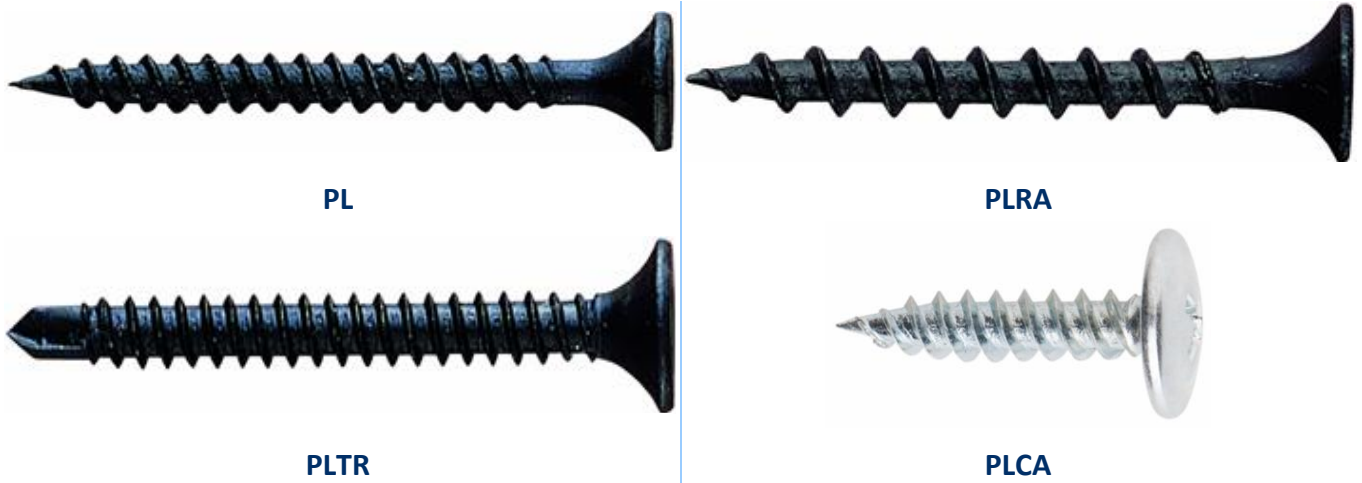

CHARACTERISTICS

- Needle S point: it drills metals up to 0.6 mm thick directly
- 60° tapping thread
- Coating: zinc plated (PLCA) or phosphate. The coating eases the adherence of the filler putty to the head of the screw.
- DIMENSIONS: $\varnothing 3.5 \div \varnothing 4.8$
- Material: special steel with heat treatment

APPLICATIONS

- Fixing of plasterboards or isolation panels to metallic profiles of 0.6 ÷ 3.0 mm maximum thickness or wood.
- Fixing of plasterboards or plasterboards to wood.

BASE MATERIALS

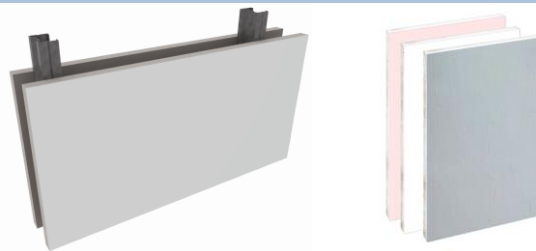

APPLICATION EXAMPLES



SCREWS FOR DRYWALLS

Name: **Drywall screws**



Codes: **PL, PLRA, PLTR, PLCA**

Reference: **FT PLA-es**

Date: **23/11/17**

Revision: **6**

Page: **2 de 6**

	PL	PL-RA	PL-TR	PL-CA
				
Material to be fixed	Drywall-metal	Drywall-Drywall	Drywall-metal	Panel yeso laminado-metal
Head	Bugle	Bugle	Bugle	Alomada baja + arandela
Recess	Ph #2	Ph #2	Ph #2	Ph #2
Point	S: needle	S: needle	Selfdrilling	S: perforante
Metal drilling capacity [mm]	≤ 0.6	---	0.6 – 3.0	≤ 0.6
Thread	Twinfast	Coarse	tapping	Paso normal
Coating	Phosphated	Phosphated	Phosphated	Zinc plated
Recommended load [kg]	25	---	20	25

SCREWS FOR DRYWALLS

Name: Drywall screws

Codes: PL, PLRA, PLTR, PLCA

Reference: FT PLA-es

Date: 23/11/17

Revision: 6

Page: 3 de 6

1. PL

Drywall screw for plasterboard



Main use

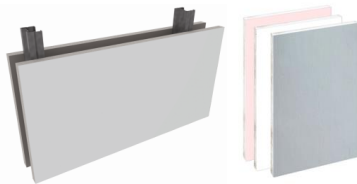

Drywall

Properties



Light load



Properties



Ph #2

1.1. Characteristics and advantages

- S needle point: it allows penetration in soft materials and metallic profiles up to 0.6 mm thick.
- Coating: phosphated (up to PL42065) and zinc (from PL42075)
- Application: fixing of plasterboards or isolation panels to metallic profiles of 0.6 mm maximum thickness. (Inner profiles)
- Twinfast thread

1.2. Data

Code	ST 3.5	ST 3.9	ST 4.2	ST 4.8
dk: head diameter [mm]	8.5	8.5	8.5	9.4
C: head washer thickness [mm]	0.85	0.85	1.00	1.00
D: outer thread diameter [mm]	3.50	3.90	4.20	4.80
d: inner thread diameter [mm]	2.18	2.34	2.50	3.1
p: pitch [mm]	1.49	1.69	1.81	2.30
l: lengths [mm]	19 - 55	25 - 58	65 - 75	90 - 130
Coating	Phosphated	Phosphated	Phosphated	Phosphated
Bit codes (Ph recess)	PUPHC02 PUPHL02	PUPHC02 PUPHL02	PUPHC02 PUPHL02	PUPHC02 PUPHL02
Loads	ST 3.5	ST 3.9	ST 4.2	ST 4.8
Recommended load [kg]	25	25	25	25

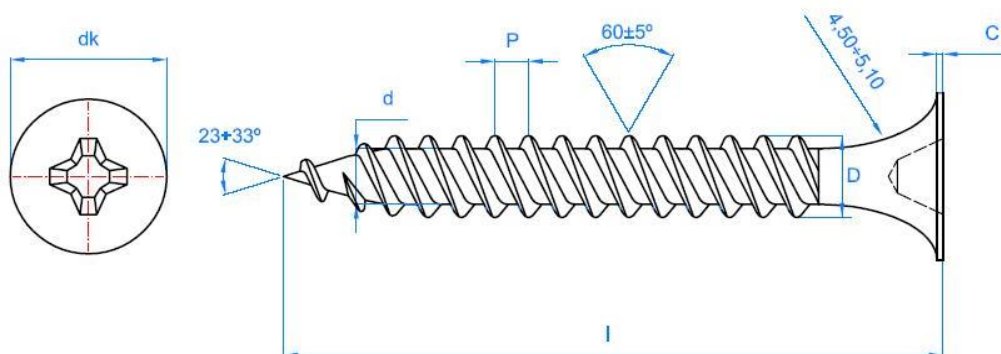

SCREWS FOR DRYWALLS

Name: Drywall screws

Codes: PL, PLRA, PLTR, PLCA

Reference: FT PLA-es

Date: 23/11/17

Revision: 6

Page: 4 de 6

2. PLRA

Drywall screw coarse thread



Properties



Light loads



Ph #2



Phosphated coating

Main use

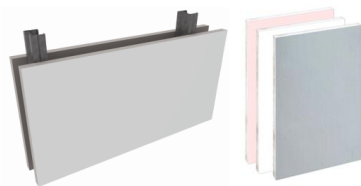

Drywall

Properties



1.3. Characteristics and advantages

- S needle point: it allows penetration in soft materials and wood.
- Phosphated coating.
- Application: coarse thread to fix drywalls or drywalls to wood.
- Coarse thread which allows a faster installation.

2.2. Data

Code	ST 3.9	ST 4.8
dk: head diameter [mm]	8.5	9.4
C: head washer thickness [mm]	0.85	1.00
D: outer thread diameter [mm]	3.90	4.80
d: inner thread diameter [mm]	2.80	3.5
p: pitch [mm]	2.80	3.10
l: lengths [mm]	25 - 55	35
Coating	Phosphated	Zinc
Bit codes	PUPHC02	PUPHC02
(Ph recess)	PUPHL02	PUPHL02

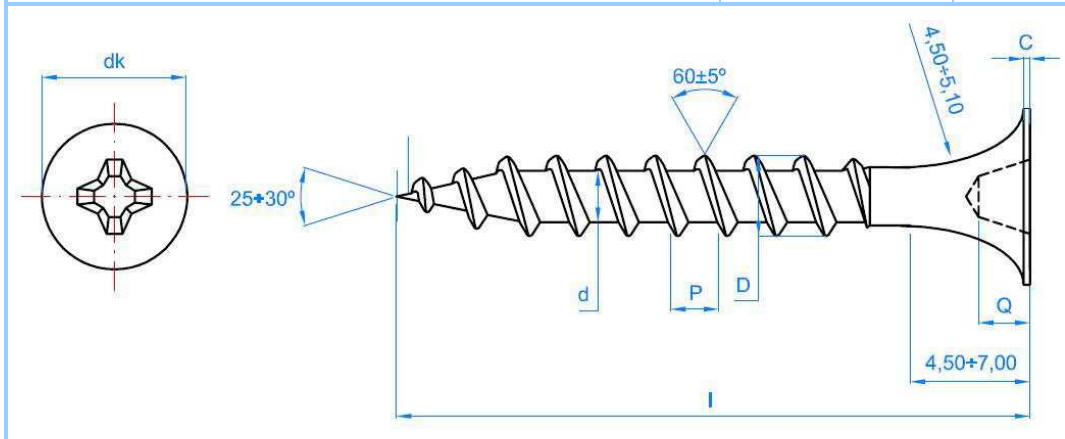

SCREWS FOR DRYWALLS

Name: Drywall screws

Codes: PL, PLRA, PLTR, PLCA

Reference: FT PLA-es

Date: 23/11/17

Revision: 6

Page: 5 de 6

3. PLTR

DRYWALL SELDRILLING SCREW



Main use

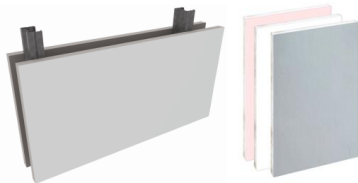

Drywall

Properties



Light loads



Ph #2



Phosphated coating

Properties



3.1. Characteristics and advantages

- Selfdrilling point and tapping thread: it allows drilling metallic materials without pilot hole, up to 3.0 mm thickness.
- Phosphated coating
- Application: fixing drywall or isolation panels to 0.6-3.0 mm thick metallic profiles. (Inner profiles)
- Selfdrilling thread.

3.2. Data

Code	ST 3.5
dk: head diameter [mm]	8.5
C: head washer thickness [mm]	0.85
D: outer thread diameter [mm]	3.50
d: inner thread diameter [mm]	2.80
p: pitch [mm]	1.60
l: lengths [mm]	25 - 45
Coating	Phosphated
Bit codes (Ph recess)	PUPHC02 PUPHL02
Loads	ST 3.5
Recommended load [kg]	20

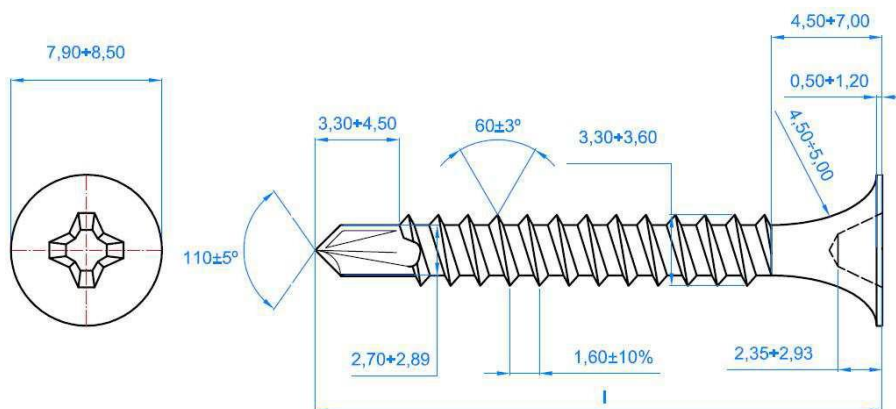

SCREWS FOR DRYWALLS

Name: Drywall screws

Codes: PL, PLRA, PLTR, PLCA

Reference: FT PLA-es

Date: 23/11/17

Revision: 6

Page: 6 de 6

4. PLCA

Drywall screw, flat head with washer



Main use

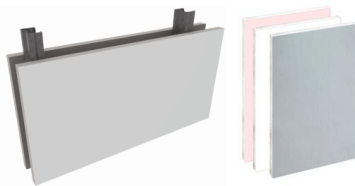

Drywall

Properties



Light loads



Ph #2



Zinc coating

Properties

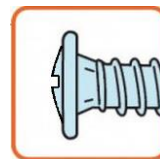

4.1. Characteristics and advantages

- S needle point: it allows penetration in soft materials and metallic profiles up to 0.6 mm thick.(Inner profiles)
- Zinc coating.
- Application: fixing of plasterboards or isolation panels to metallic profiles of 0.6 mm maximum thickness. (Inner profiles)
- Twinfast thread.

4.2. Data

Code	ST 4.2
dk: head diameter [mm]	10.50 – 11.00
C: head washer thickness [mm]	1.20
D: outer thread diameter [mm]	4.10 – 4.30
d: inner thread diameter [mm]	2.60
p: pitch [mm]	1.60
l: lengths [mm]	13 - 51
Coating	Zinc
Bit codes (Ph recess)	PUPHC02 PUPHL02
Loads	ST 4.2
Recommended load [kg]	25

